

# Area Scan lens

## A9-1228-6MP



### Features

- Support up to 1/1.8" camera sensors;
- 6 models, focal length covering from 8mm to 50mm;
- High resolution for 6MP camera in full of view , high edge definition ;
- Design for close working distance , more suitable for industrial vision inspection scenarios ;
- Ultra low distortion ;
- Stable sharpness quality when temperature varies from -20°C~50°C ;

### Dimensions (mm)

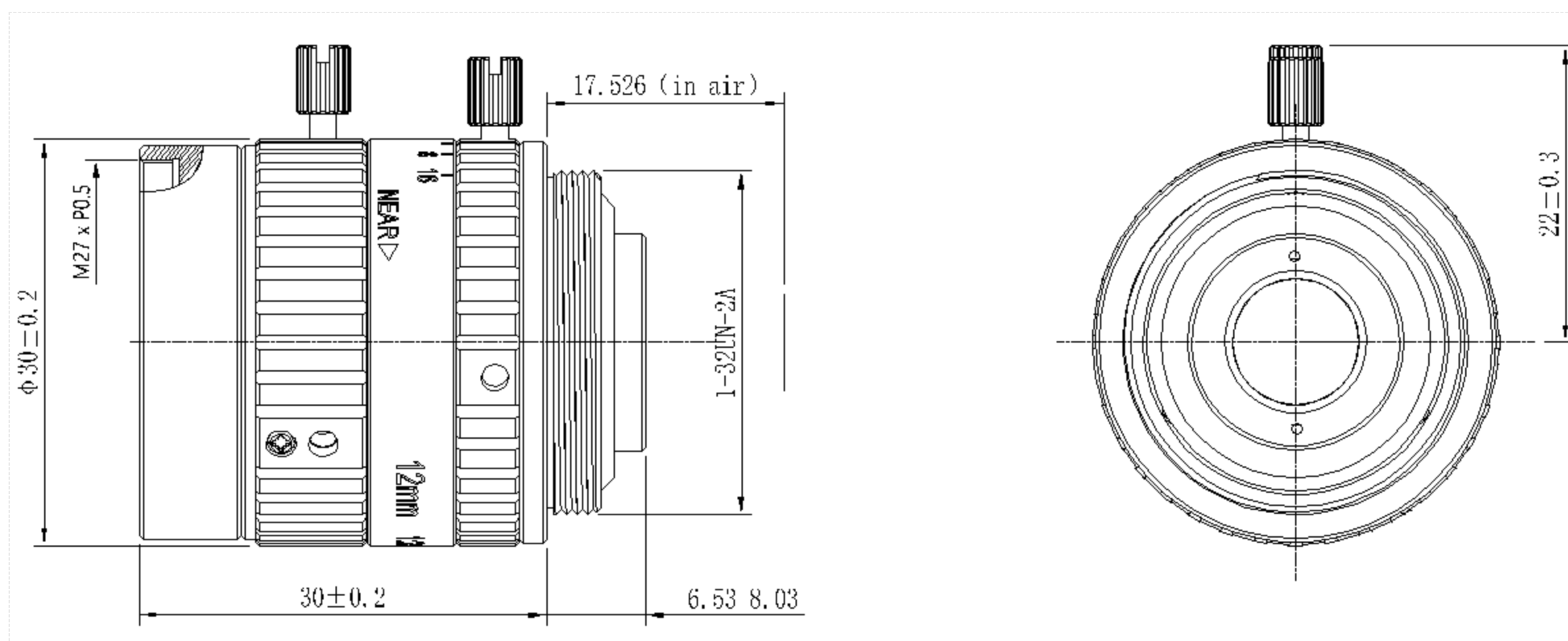



/ Specification

Model		A9-1228-6MP
Basic	Series	A9-6MP Series
	Model	A9-1228-6MP
	Focal Length	12 mm
	Aperture	F2.8 - 16
	Image Sensor Size	Φ9.4 mm(1/1.8")
	Focus Range	0.1 m to infinite
	Optical Distortion	0.1%
	TV Distortion	0.05%
	Field of View	42.2°×34.96°×23.7° (9 mm×7.4 mm×4.9 mm)
	Relative Illumination	78% (F2.8); 92% (F4.0)
	CRA ( Chief Ray Angle)	7.9°
	Spectral Range	436 nm~656 nm
	Spectral Transmission	T > 85%
Structure	Camera Mount	C - Mount
	Filter Thread	M27×P0.5
	Focus Control	Manual
	Iris Control	Manual
	Product Dimensions	30×Φ30 mm
	Net Weight	48±5 g
Environment	Operating Temperature	-20°C ~ +50°C